

# RETAIL AIR SYSTEMS

P.O. Box 21532  
 Chattanooga, TN 37424  
 PH (800) 245-8104 / Fax (423) 553-1008

APPROVED BY: \_\_\_\_\_

DATE APPROVED: \_\_\_\_\_

## CPT-2 (Large to Small) Transition-Curb System

### STANDARD FEATURES

1. 14 Ga. Prime Galvanized Steel Construction.
2. Fully Welded Watertight One-Piece Construction.
3. Prime Painted after Fabrication.
4. 1" Thick, Neoprene Faced Fiberglass Insulation.
5. Closure Angles.
6. Load Distributing Internal Reinforcement (As Required).
7. Duct Supports & Gasketing (When Required).

### OPTIONS

1. Supply & Return Air Transitions.
- 2.
- 3.
- 4.

PROJECT NAME: \_\_\_\_\_

CITY, STATE: \_\_\_\_\_

CUSTOMER: \_\_\_\_\_

JOB NUMBER: \_\_\_\_\_

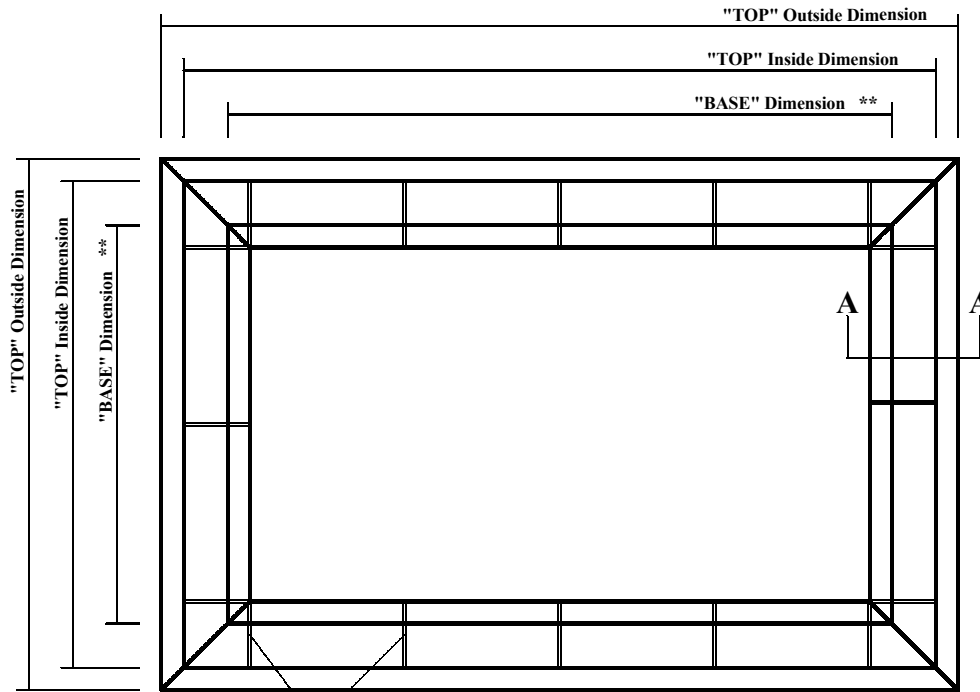

Internal Reinforcing  
(As Required)

PLAN VIEW

Internal Reinforcing  
(As Required)

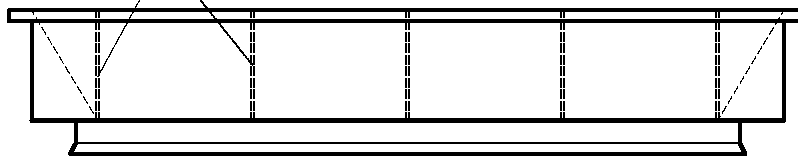

ELEVATION

### Note:

- \*\* (1) Base Dimension = Curb O.D. plus 1-1/2" on all "Insulated" Conventional Roof Curbs (CPC-1, 2, 3) and, 1/2" on all Metal Building Roof Curbs, and "Non-Insulated" Conventional Roof Curbs (CPC-4, 5).

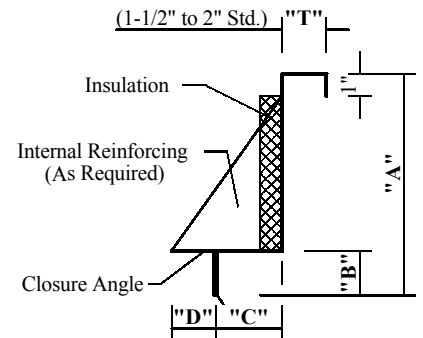

SECTION A-A

QTY.	"BASE" DIM.	"TOP" INSIDE DIM.	"TOP" OUTSIDE DIM.	"T"	"A"	"B"	"C"	"D"	TAG
	x	x	x						